

PRESTIGE

TANK

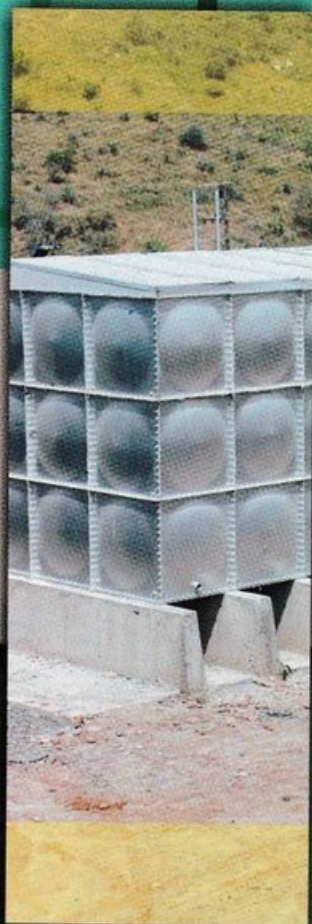

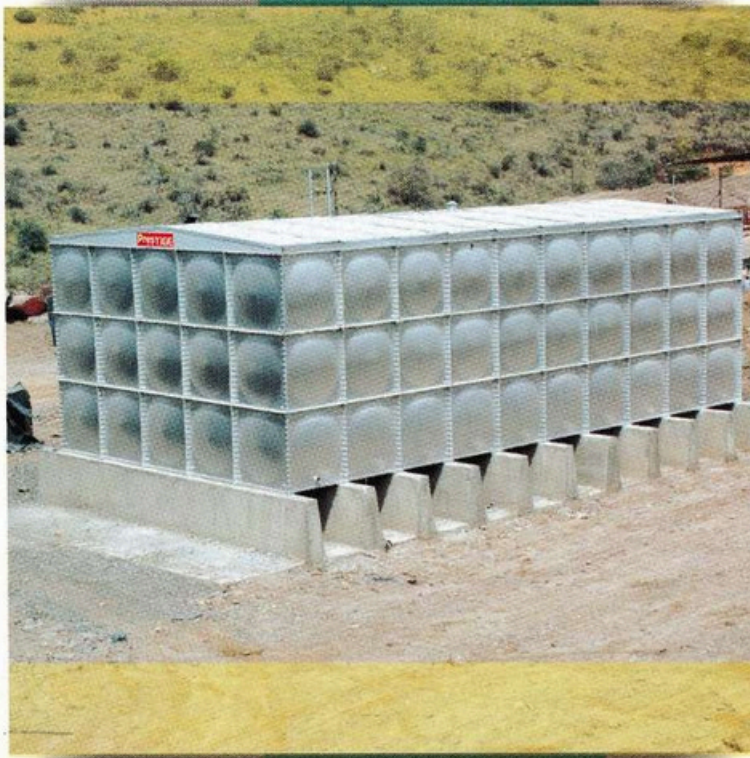

WATER STORAGE NECESSITY

Water is a basic human right and this natural resource has great social and economic value.

Unfortunately, the water resources are unevenly distributed and hence the need to collect and conserve it.

With the need to conserve water, "David Engineering Ltd" has been the leader in offering solutions to water storage problems based on sound engineering principles and state of the art technology in East and Central Africa.

GENERAL

Prestige Tanks with enviable reputation for quality and reliability are manufactured to BS 5644:1975 type 2 and local standards.

The capacity ranges from 1m³ to an almost infinitely extendable capacity. Our wide experience in prestressed steel tanks has enabled our tanks to stand the test of time and with our highly experienced erection team, we assemble the tanks and towers over a variety of sites even the most inaccessible locations both locally and in other countries.

CONSTRUCTION

Prestige Tanks are bolted mild steel sectional water storage containers manufactured from 1m² and 1.22m² panel sizes.

Depending on the contained liquid pressure, the thickness of the panel ranges between 5mm to 6mm. To ensure further that the tension due to internal pressure results in no leakage, mild steel angle stays are provided with a jointing strip along the flange joints.

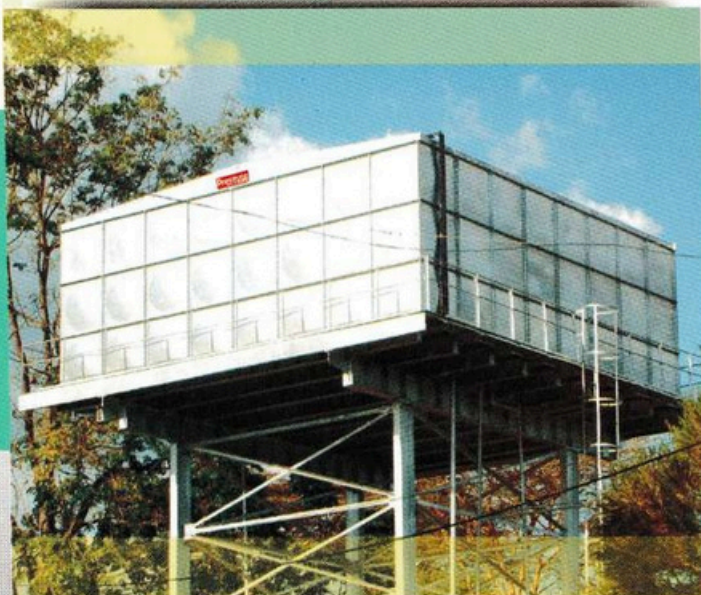

To keep off dust and avoid any contamination of the content, the tanks are provided with cover/roof designed to support the maintenance personnel and their equipments.

For accessibility, the roofs are fitted with a lockable and sealed manhole.

ACCESSORIES

Our tanks are supplied complete with the following necessary accessories:

- Internal and external ladders
- Level indicator

PROTECTIVE TREATMENT

The tank panels are normally wire brush cleaned and painted externally with one coat of primer and two coats of bright aluminium paint or any other paint as per customer's request. Internally, two coats of non-toxic bituminous paint are applied.

The tanks exterior is then touched up with silver aluminium to cover any marks/scratches developed in the course of site assembly.

On customer's request, we also provide galvanized steel panel tanks with galvanizing done to the locally available standards. Other types of protective paint can also be provided on request.

MILD STEEL TOWERS

To allow for gravity flow in the distribution system, the tanks are erected on mild steel towers fully designed to BS 5950 Part 1/CP3 chapter 5 and height to customer's requirements.

When specifying tower requirements it is advisable to anticipate future increases in tank capacity.

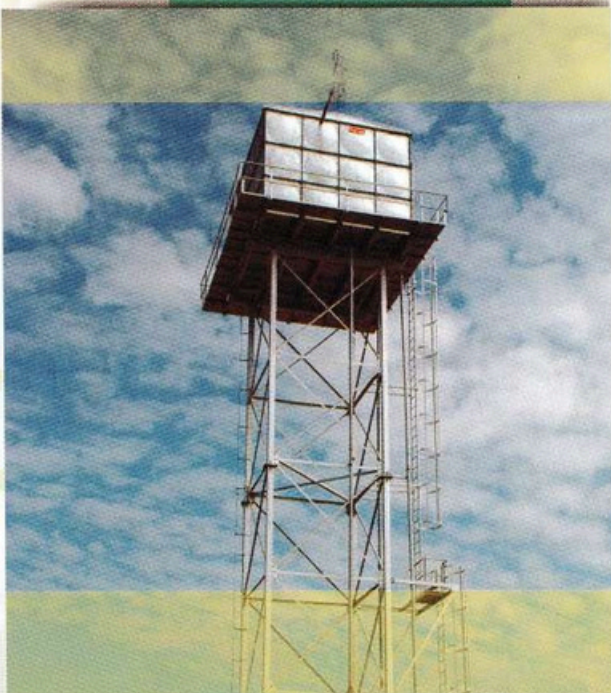
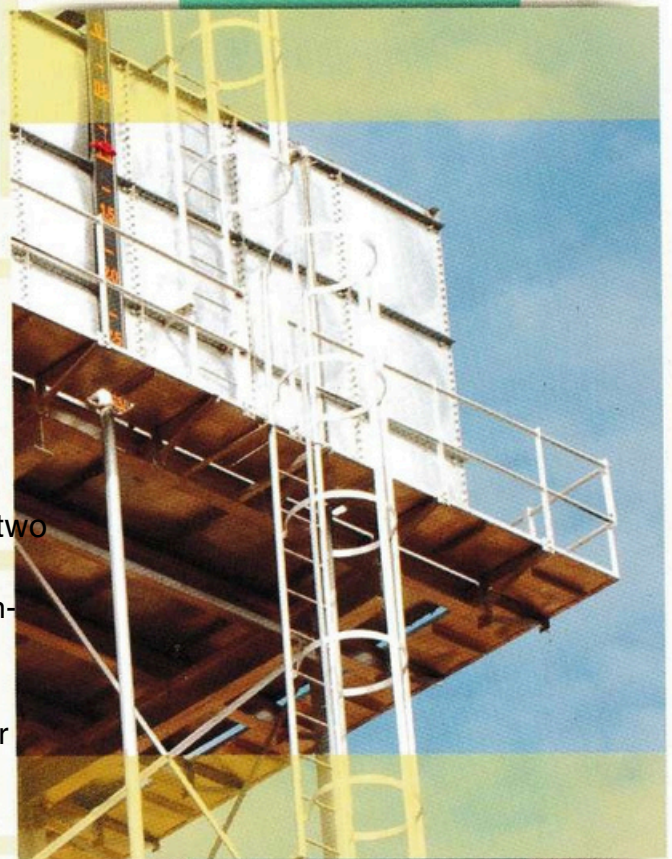

ADVANTAGES OF PRESTIGE TANK

Due to the nature of design, production and erection techniques applied on the Prestige tanks, our clients have benefited and enjoyed the following advantages:

- The tanks are simple and quick to assemble with hand tools and minimum skilled labour.
- Our Prestige tanks are portable in design which is ideal for sites with limited access and shipments.
- The tanks have unlimited capacity and they are ideal for temporary requirement due to the simplicity in erection and dismantling.

FOUNDATION FOR GROUND TANK (TYPICAL)

THIS FOUNDATION CAN BE REINFORCED CONCRETE STUB OR SOLID BLOCK DWARF WALL BOTH WITH A REINFORCED CONCRETE SLAB. IT IS DESIGNED TO SUIT SITE CONDITIONS AND SIZE OF THE TANK AS SHOWN ON THE DIAGRAMS BELOW.

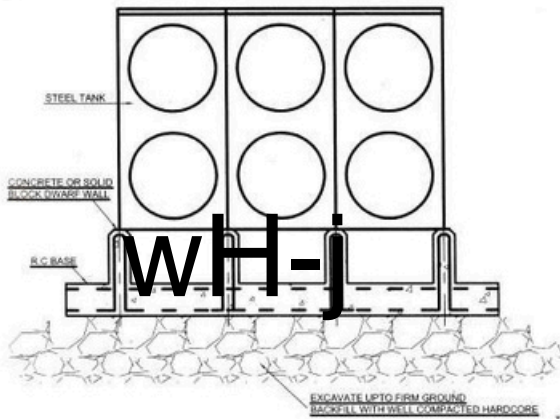

GROUND TANK FOUNDATION DETAILS

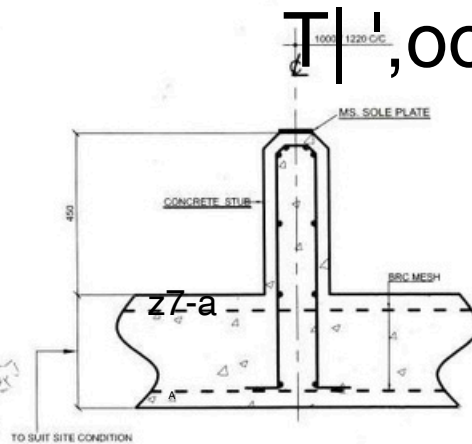

**CONCRETE STUB WALL DETAIL
(OPTION 1)**

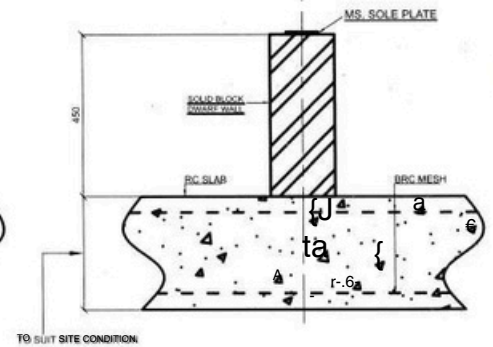

**DWARF WALL DETAIL
(OPTION 2)**

FOUNDATION FOR TOWER (TYPICAL)

THIS FOUNDATION CAN BE REINFORCED OR MASS CONCRETE TO SUIT SITE CONDITIONS AS SHOWN ON THE DIAGRAMS BELOW.

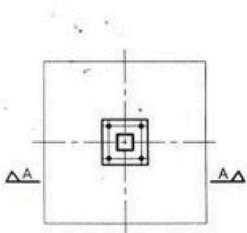

PLAN VIEW

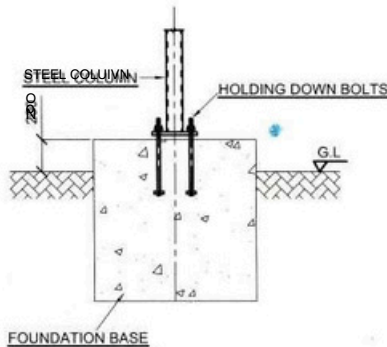

SECTION A-A

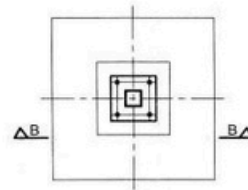

PLAN VIEW

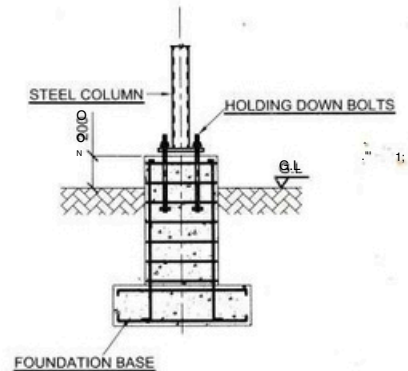

SECTION B-B

MASS CONCRETE FOUNDATION DETAILS

REINFORCED CONCRETE FOUNDATION DETAILS

INTERNAL VIEW OF THE TANK

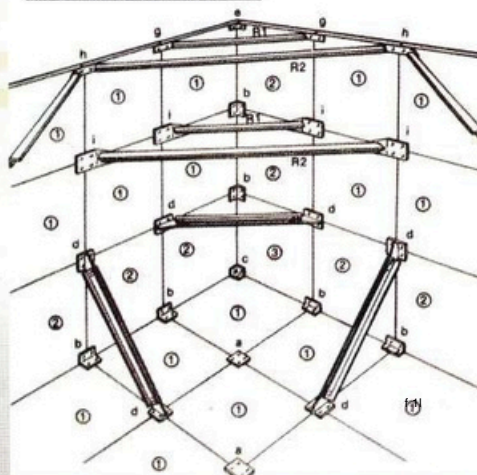

This is a typical range of capacities only. Many other sizes are available as well.

Plates 1M X 1M

Nominal Tanks size Length x Breadth m x m	1 Meter Deep	2 Meter Deep
2 x 1	2 000	4 000
3 x 1	3 000	6 000
4 x 1	4 000	8 000
2 x 2	4 000	8 000
3 x 2	6 000	12 000
4 x 2	8 000	16 000
5 x 2	10 000	20 000
3 x 3	9 000	18 000
4 x 3	12 000	24 000
5 x 3	15 000	30 000
6 x 3	18 000	36 000
4 x 4	16 000	32 000
5 x 4	20 000	40 000
6 x 4	24 000	48 000
7 x 4	28 000	56 000
8 x 4	32 000	64 000
5 x 5	25 000	50 000
6 x 5	30 000	60 000
6 x 6	36 000	72 000
7 x 6	42 000	84 000
7 x 7	49 000	98 000

Nominal Tanks size Length x Breadth m x m	3 Meter Deep	4 Meter Deep
3 x 3	27 000	36 000
4 x 3	36 000	48 000
4 x 4	48 000	64 000
5 x 4	60 000	80 000
5 x 5	75 000	100 000
6 x 5	90 000	120 000
6 x 6	108 000	144 000
7 x 6	126 000	168 000
8 x 6	144 000	192 000
7 x 7	147 000	196 000
8 x 7	168 000	224 000
9 x 7	189 000	252 000
8 x 8	192 000	256 000
9 x 8	216 000	288 000
10 x 8	240 000	320 000
9 x 9	243 000	324 000
10 x 10	300 000	400 000
11 x 10	330 000	440 000
11 x 11	363 000	484 000
12 x 11	396 000	528 000
12 x 12	432 000	576 000
13 x 12	468 000	624 000
13 x 13	507 000	676 000

Plates 1.22M X 1.22M

Nominal Tanks size Length x Breadth m x m	1.22 Meter Deep	2.44 Meter Deep
2.44 x 1.22	3 600	7 200
3.66 x 1.22	5 400	10 800
4.88 x 1.22	7 200	14 500
2.44 x 2.44	7 200	14 500
3.66 x 2.44	10 800	21 780
4.88 x 2.44	14 500	29 000
6.1 x 2.44	18 100	36 300
3.66 x 3.66	16 300	32 600
4.88 x 3.66	21 700	43 500
6.1 x 3.66	27 200	54 400
7.32 x 3.66	32 600	65 300
8.54 x 3.66	38 100	76 250
4.88 x 4.88	29 000	58 100
6.1 x 4.88	36 300	72 600
7.32 x 4.88	43 500	87 150
8.54 x 4.88	50 800	101 650
9.76 x 4.88	58 100	116 200
6.1 x 6.1	45 380	90 780
7.32 x 6.1	54 450	108 950
7.32 x 7.32	65 370	130 700
8.54 x 8.54	88 900	177 950

Nominal Tanks size Length x Breadth m x m	3.66 Meter Deep	4.88 Meter Deep
3.66 x 3.66	49 000	65 370
4.88 x 3.66	65 370	87 160
4.88 x 4.88	87 160	116 200
6.1 x 4.88	108 950	145 260
6.1 x 6.1	136 100	181 500
7.32 x 6.1	163 400	217 900
7.32 x 7.32	196 100	261 480
8.54 x 7.32	228 750	305 000
8.54 x 8.54	266 900	355 900
9.76 x 8.54	305 000	406 700
10.98 x 8.54	343 150	457 550
9.76 x 9.76	348 600	464 850
10.98 x 9.76	392 200	522 950
12.2 x 9.76	435 800	581 000
10.98 x 10.98	441 250	588 300
12.2 x 10.98	490 250	653 700
12.2 x 12.2	544 750	726 300
13.42 x 12.2	599 200	798 950
13.42 x 13.42	659 150	878 870
14.64 x 13.42	719 000	958 760
14.64 x 14.64	784 000	1 045 928
15.86 x 14.64	849 800	1 133 000
15.86 x 15.86	920 600	1 227 500